ASSEMBLY INSTRUCTIONS

STAVES LINING



HOW TO ASSEMBLE THE CASE AND THE CONTROL PANEL

- 1) Wrap the fiberglass around the boiler body and use the supplied strap to secure it (see fig.).

DIAGRAM OF PLASTIC STRAP LOCKING
TO SECURE THE FIBERGLASS
TO THE BOILER SHELL

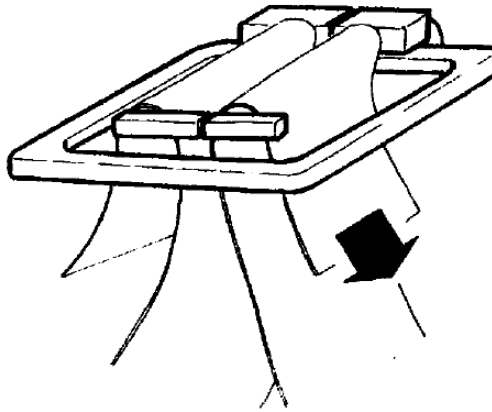

- 2) Prepare the staves by inserting the four stoppers, as shown in the figure.

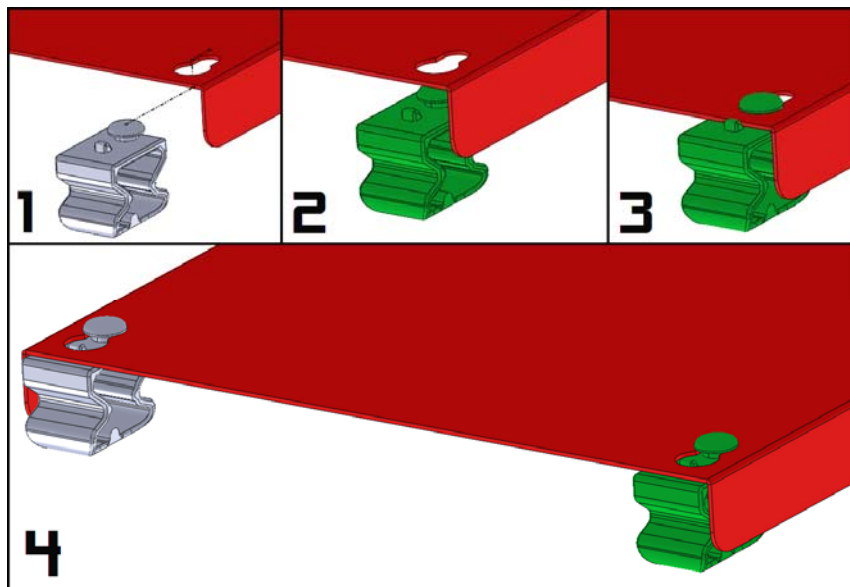

3) Fasten the uprights and the beams to the plates by means of appropriate screws and nuts.

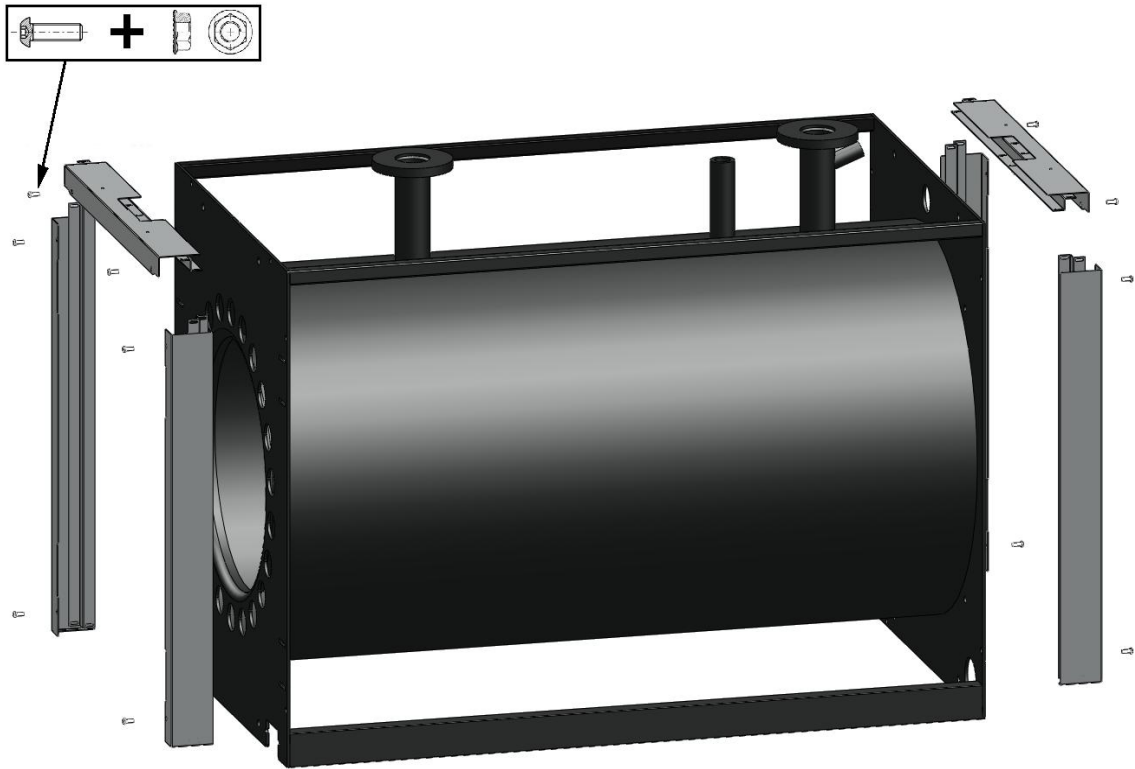

NOTE: the beam shown in the figure, if supplied in the package, must be placed between the two tube panels in order to support the staves.

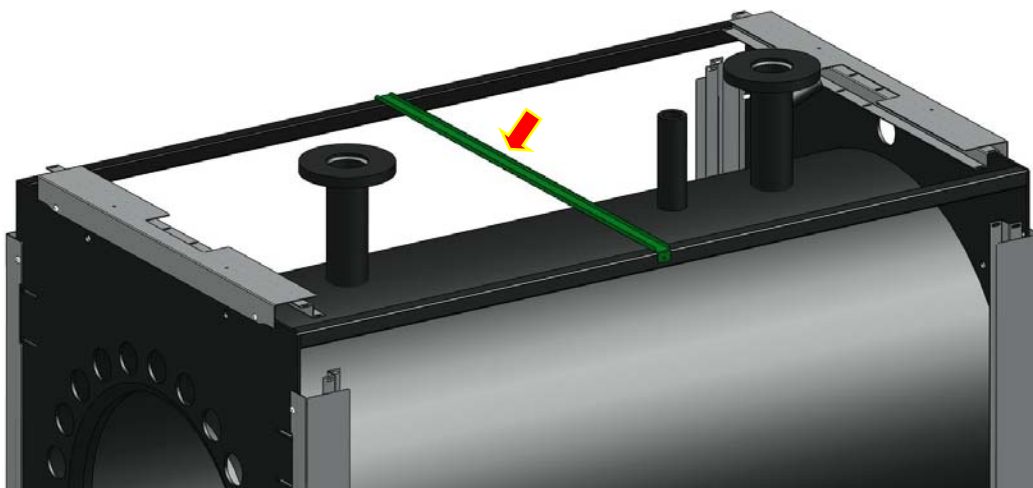

- 4) Insert the staves, with the previously installed stoppers, between the uprights and the beams, as shown in the figure.

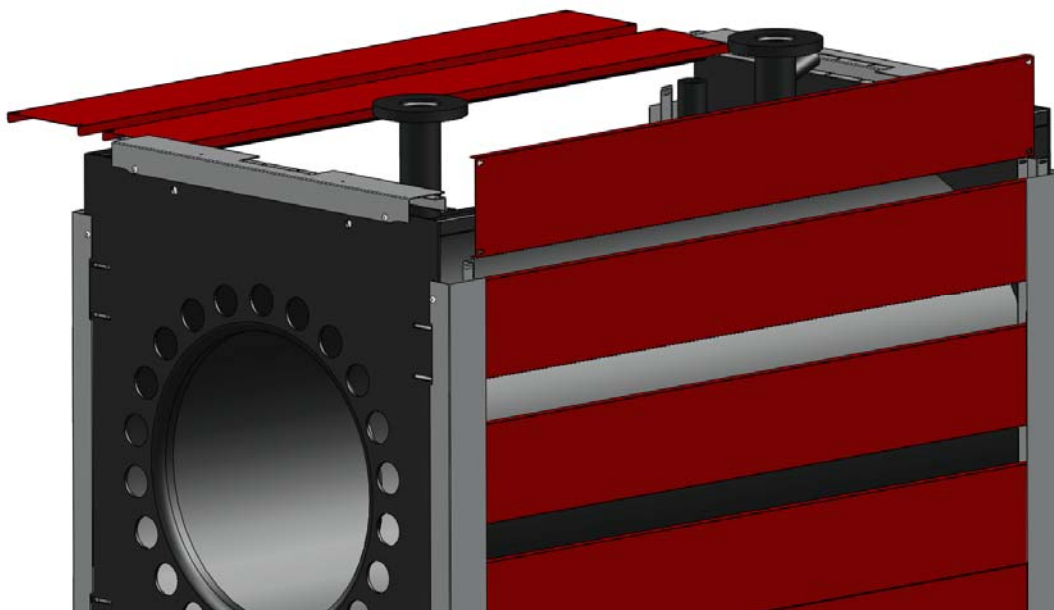

- 5) After all staves have been inserted, install the closing frame using the self-locking screws.

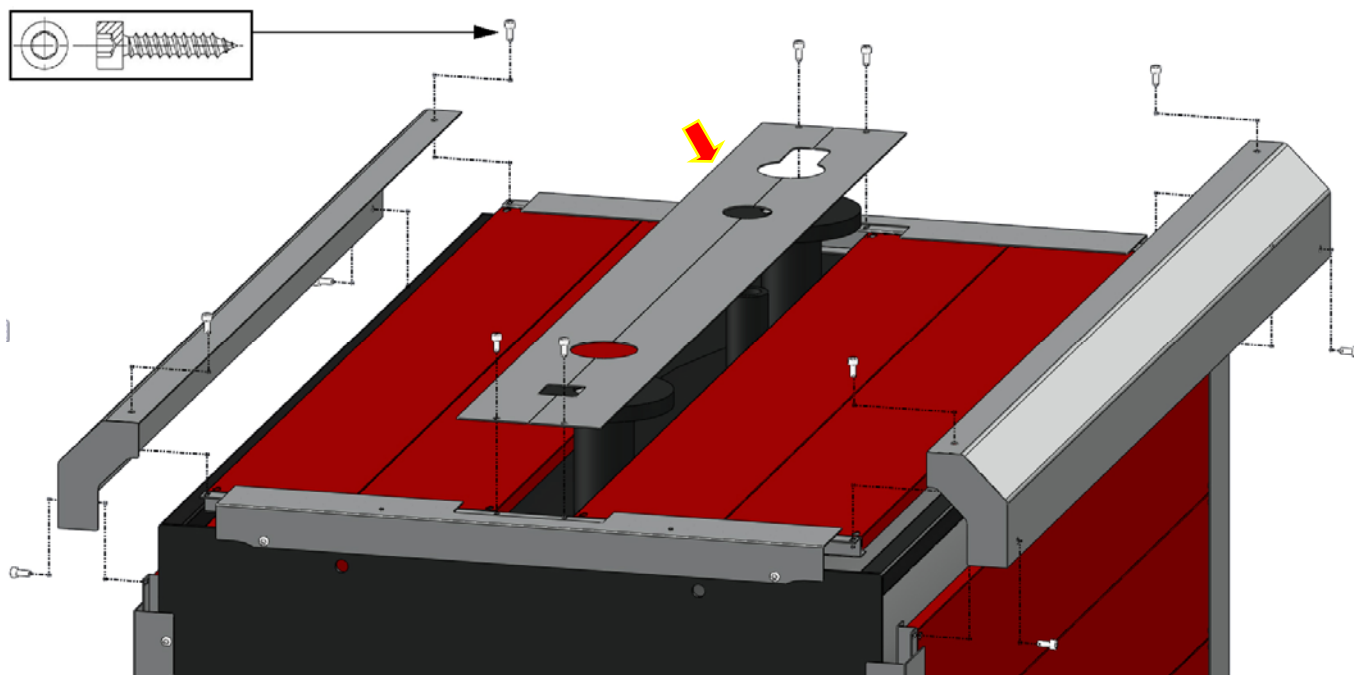

NOTE: If the boiler has upper connections it is necessary to install the special central covers, as shown in the figure. If that's not the case, completely cover with staves the upper part and close the boiler with the side frames.

CONTROL PANEL INSTALLATION

The control panel supplied with the boiler must be installed on the special support supplied in the kit, which must be fastened to the boiler front beam. Pass the cables through the loopholes within the structure (see the figure).

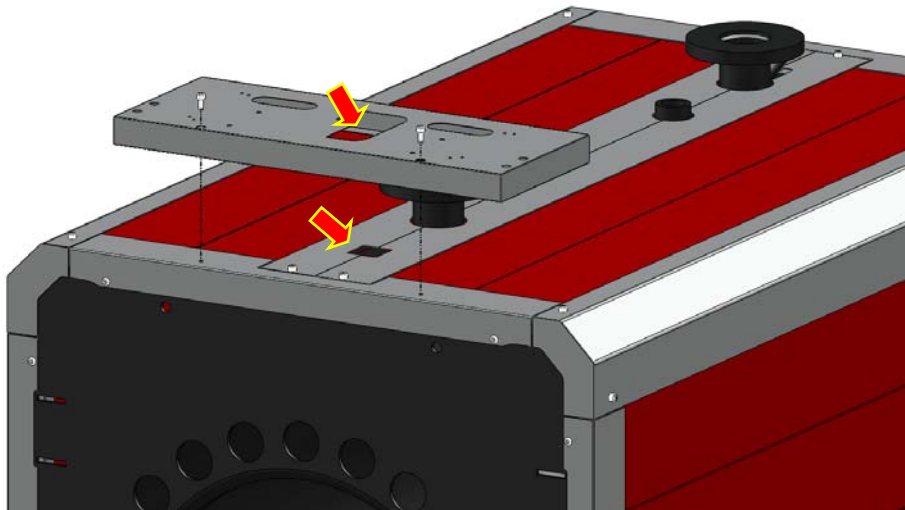

NOTE: if the panel supporting stave is included in the kit (containing the screw holes and the capillar eyelets) it is recommended that you use it to facilitate adjustment; in this case the panel can be installed both on the left-hand and the right-hand side of the wall.

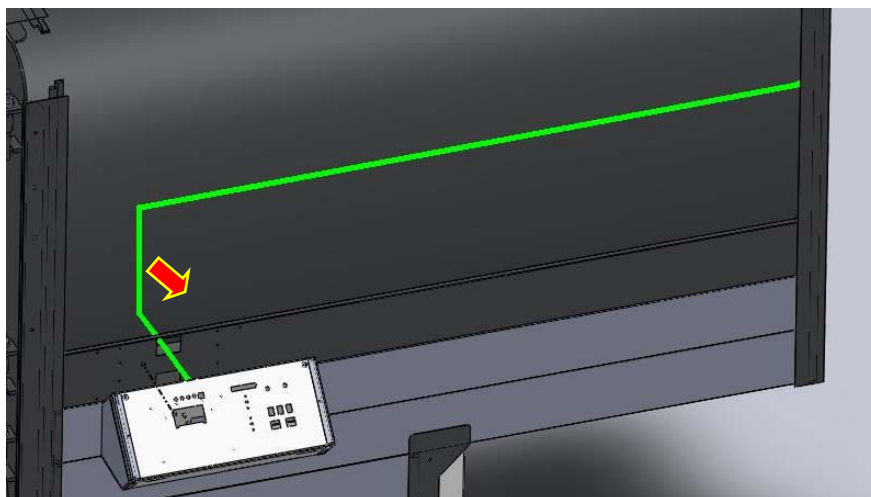

The data listed is indicative only and is not binding. Our company reserves the right to introduce alterations at any time as it deems fit and proper for the development of the product.
